

Measurements
 Length760 mm
 Width175 mm
 Height210 mm
 Weight2.0 kg

Chassis and superstructure
 Frame made of aluminium section, 2 mm thick; torsion resistant.
 Rear bumper made of section 2 mm thick.
 3-part stainless steel leaf spring packages on all axles.
 Soft rubber tires with reproduction of original tread pattern.
 Fastening components made of stainless steel.
 High impact plastic components.

Assembly
 During assembly it is advisable following the sequence given by these instructions. Observe the notes explaining the various steps in assembly and use only those parts which are provided; this will insure a correct result of assembly. WEDICO Kits are known for their exact fit

Accessories (options):

- Double Landing Gear
for Semi-Trailers Art.-No. 424
- Equipment and Tool Box Art.-No. 402
- Air Tank Art.-No. 401

For various other possibilities of outfit please find our suggestions and tips in the WEDICO catalog.

We are glad that you have decided on one of the precious WEDICO truck models! For the manufacture of individual parts WEDICO uses durable materials of high quality - rarely to find in these days. This guarantees durability and enjoyment of your model for years to come.

If you should ever require **replacement parts**, please get in touch with your dealer or directly with WEDICO. For order purpose it is important using not only those **EDP-numbers** mentioned within the general parts list (see last page of this instruction) but also indicating the necessary details concerning colour, quantity and exact term of the spares required. You may be assured that WEDICO will supply the replacement part as quick as possible.

© 1995 by WEDICO, P.O. Box 20 04 18, D - 42 204 Wuppertal, Germany.
 We can assume no liability for technical or typographical errors.
 We reserve the right to incorporate technical modifications.
 Duplication and reproduction only with our express consent.

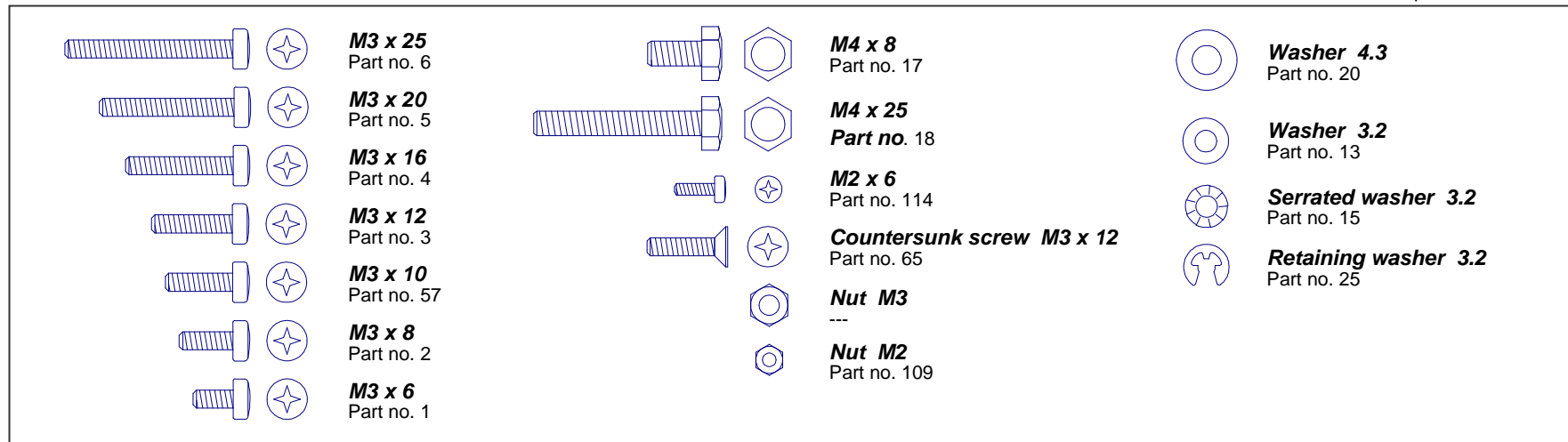

Flatbed Semi-Trailer Completion of assembly groups

1 General

1.1 The assembly instruction

On the left side you find the illustrations of the assembly groups including the part lists indicating the necessary components. On the right side, marked by the corresponding number of illustration, the instructions for the proper assembly.

1.2 Screws and other small parts

M3 nuts are generally not provided with an identification number. As a help easier to find out screws and small parts, please see ill. 1 which is showing you the most important components at original size.

2 Components attached to the frame

2.1 Assembly of the axle carriers

Mount the axle carriers **173** inside onto the frame **181** with screws **2** and nuts M3. You will find the upper column of bores sloped; once the axle carriers are attached, the rear part of the frame is laying lower than the front part.

2.2 Assembly of the landing gear

Before attaching the landing gear place both cables of the electrical equipment between shaft and frame.

Fix the landing gear wheels **178** with screws **5**, washers **13** and nuts M3 onto both sides of the strut **177**. Pin a spring **176** onto the landing gear lever **175** and insert the unit into the centre bore of the landing gear strut **177**. Then lead the lever through the lateral flattening of the frame.

Insert the shaft **73** into the lateral bore of the frame; slide on -one after the other- one spring **174**, the landing gear strut and the second spring **174**. Secure the shaft on both sides using the retaining washer **25**.

2.3 Assembly of the kingpin

→ **When changing the standard fifthwheel of your prime mover to the Aluminium Fifthwheel, Art.-No. 700:** This Container Kit does include the necessary fitting items: kingpin **643** for aluminium fifthwheel with washer **315** and countersunk screw **647**.

Press one nut M3 into the hexagonal slot on the carrier plate **179** and screw up the kingpin **180** using screws **5**. Once you have screwed the loading platform onto the chassis frame (see point 6.1), fix then with countersunk screws **65** and nuts M3 the carrier plate underneath the frame.

Before fixing the carrier plate lead both cables of the electrical system between the carrier plate and the frame (see chapter 7.1).

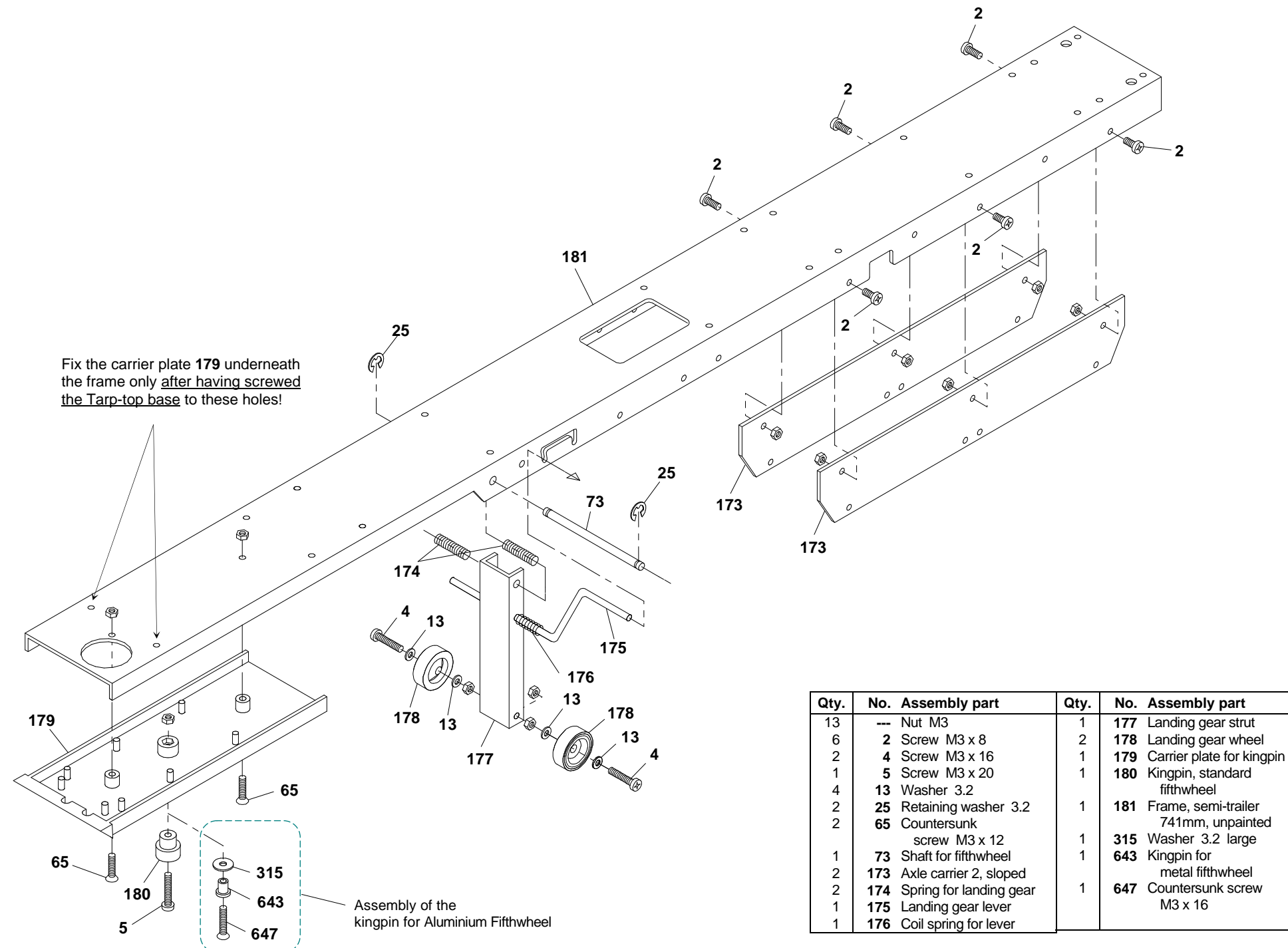

3 Assembly group rear axles

3.1 Mounting the mud guards

The mud guard support **715** marked by an "X" has to be mounted onto the right-hand side (direction of traffic), while the bracket marked "O" **716** onto the left-hand side (direction of traffic). First attach to these supports the mud flaps **717** and the mud guards **714** with each four screws **114** and nuts **109**. Then use screws **6**, serrated washers **15**, bushing **26**, two washers **13** and M3 nut to attach the supports to the rear holes on the axle carriers.

3.2 Mounting the spring set with axle

Hang both long spring leaves **32** with their open ends to the bushing and use a screw **3**, bushing **26**, washer **13** and M3 nut to screw the closed ends to the axle carrier. Press one each M3 nut into the hexagonal recess on the lower spring carrier **70**. The axle **68** can now be mounted together with the spring carriers, one medium spring leaf **33** each, a short spring leaf **34** and screws **4**.

⚠ Ensure that the sides of the spring carrier **70** marked by an "A" are mounted towards the wheel.

⚠ Mount the wheels accordingly to chapter 3.3 before you start tightening the screws **4**. Please ensure that the spring sets are not under tension and can move freely.

The assembly of the fore rear axle has to be done in the same sense but without the mudguards.

3.3 Mounting the wheels

Note: Sometimes it happens that the chromed rims sit too tightly on the axle (work tolerance); in this case remove a bit the chrome inside the rims, and lightly grease the running surface (e.g. using Vaseline).

Once you have mounted the tyres **53** onto the rims **52**, add the wheels onto the shaft, with the wheel nuts facing towards each other and the chromed rims towards the outside; secure with washer **20** and screw **17**. The wheels should turn easily but there should not be too much play.

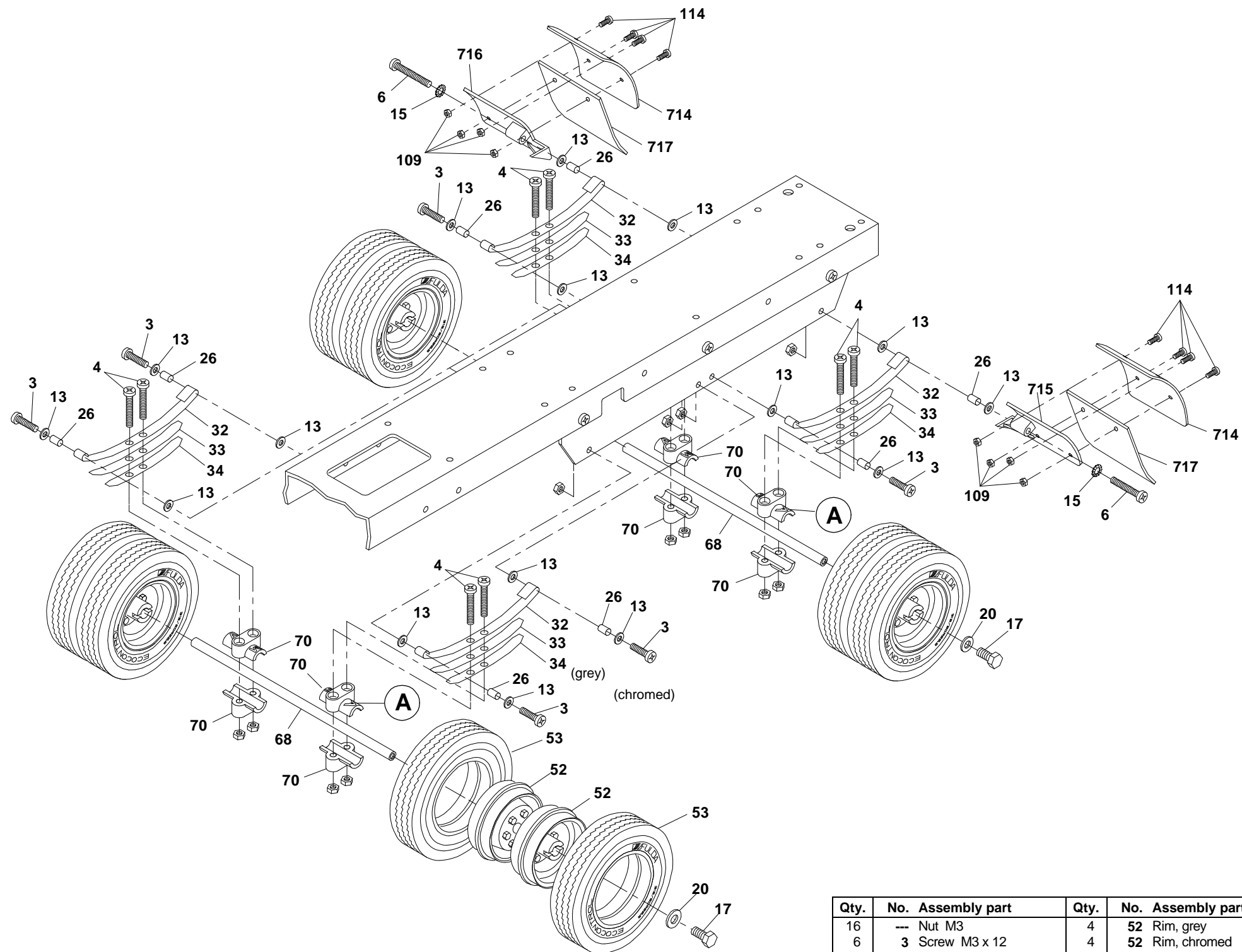

Qty.	No.	Assembly part	Qty.	No.	Assembly part
16	---	Nut M3	4	52	Rim, grey
6	3	Screw M3 x 12	4	52	Rim, chromed
8	4	Screw M3 x 16	8	53	Standard tyre "Ecocontrol"
2	6	Screw M3 x 25	2	68	Rear axle 144mm
16	13	Washer 3.2	2	70	Spring carrier, plastic
2	15	Serrated washer 3.2	8	70	Spring carrier, plastic
4	17	Hex head screw M4 x 8	8	109	Nut M2
4	20	Washer 4.3	8	114	Screw M2 x 6
8	26	Bushing 4 x 0.5 x 7	2	714	Mud guard
4	32	Spring long, "AF"	1	715	Mudguard support "X"
4	33	Spring medium, "AF"	1	716	Mudguard support "O"
4	34	Spring short, "AF"	2	717	Mud flap

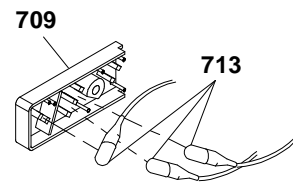
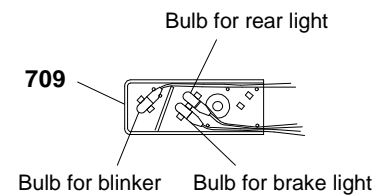

Inserting the bulbs

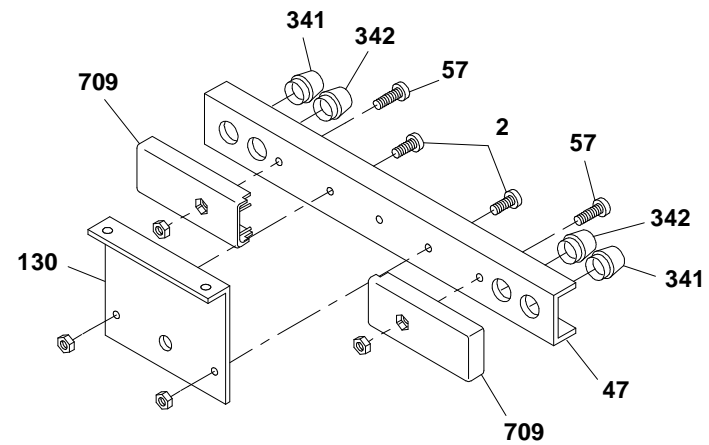

Qty.	No.	Assembly part	Qty.	No.	Assembly part
4	---	Nut M3	2	341	Blinker lens high, orange
2	2	Screw M3 x 8	2	342	Lens/rear light high, red
1	47	Bumper, rear	2	709	Lamp cap
2	57	Screw M3 x 10	6	713	Bulb 3V
1	130	Bumper bracket			

4 Preparation of the bumper

First insert the bulbs 713 in the lamp caps 709 as shown in the figure. Now affix the assembled caps to the rear bumper 47 using one each screw 57 and M3 nut. From the rear insert the lenses into the bumper: outwards the blinker lenses 341, inwards the rear light lenses 342. Use screws 2 and nuts M3 to fix the bumper bracket 130 onto the bumper.

⚠ Take particular care that the bulb cables are not clamped between the bumper and the bracket; this could cause a short circuit!

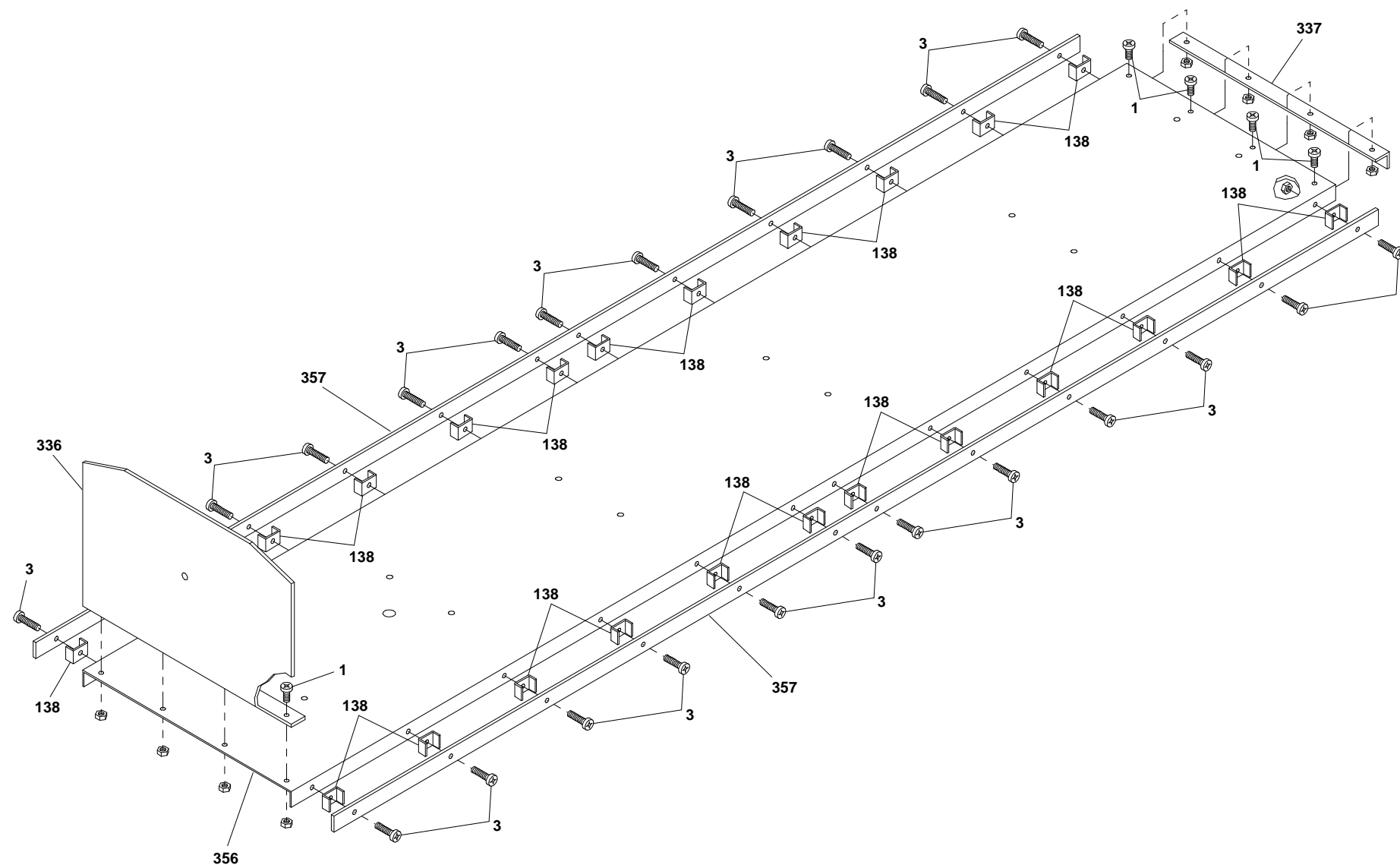

Qty.	No.	Assembly part	Qty.	No.	Assembly part
32	---	Nut M3	1	336	Head panel
8	1	Screw M3 x 6	1	337	Angled section
24	3	Screw M3 x 12	1	356	Loading platform long
24	138	Bridging clamp	2	357	Side rail long

5 Mounting the loading platform

5.1 Mounting the side rail

At first fix both side rails 357 onto the loading platform 356 using screws 3, bridging clamps 138 and nuts M3. After having finished the assembly of your flatbed model the stakes will be inserted into the bridging clamps.

5.2 Fixing the head panel

Use screws 1 and nuts M3 to screw the head panel 336 onto the loading platform.

5.3 Fixing the angled section

From underneath set the angled section 337 onto the loading platform and secure it from the top with screws 1 and from underneath with nuts M3.

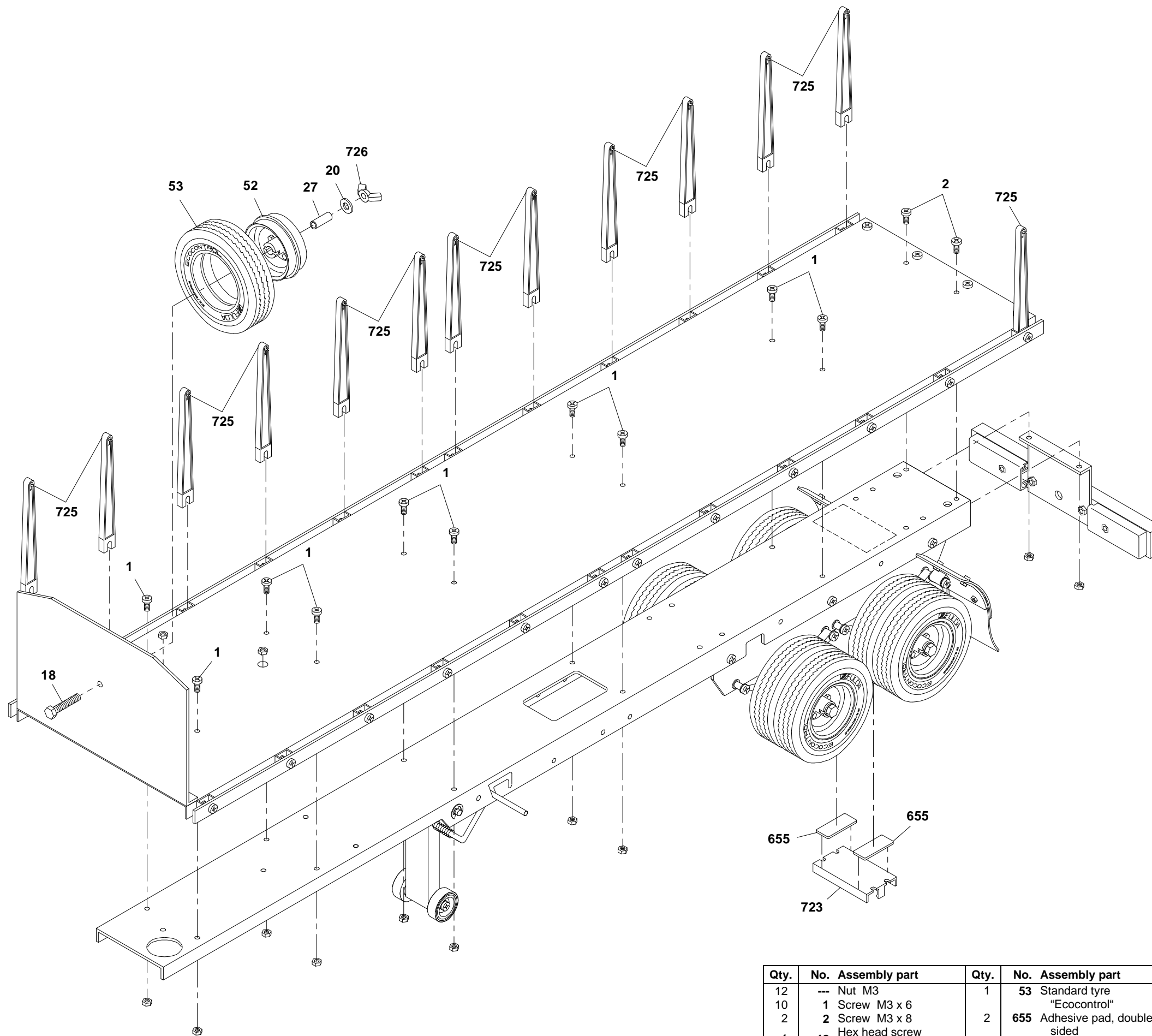

6 Final assembly

6.1 Attachment of loading platform and bumper

Lay the premounted loading platform onto the chassis frame and fix both units with screws 1 and nuts M3. Use screws 2 and nuts M3 to fix the premounted bumper underneath frame and loading platform.

6.2 Attachment of the support for PCB

Use two double-sided adhesive tapes 655 to fix the support 723 underneath the frame (see ill. 7).

6.3 Mounting of the spare wheel

Together with rim 52 fix the spare wheel 53 onto the head panel 336 (either inside or outside); use screw 18, axle tube 27, washer 20 and wing nut 726.

6.4 Attachment of the stakes

Finally set the stakes 725 into their bridging clamps and insert the chains 1202 (not illustr.) into the upper, angled slots. Slide one link of the chain in the slot and secure by rotating while pressing downward.

Qty.	No.	Assembly part	Qty.	No.	Assembly part
12	---	Nut M3	1	53	Standard tyre "Ecocontrol"
10	1	Screw M3 x 6	2	655	Adhesive pad, double-sided
2	2	Screw M3 x 8	1	723	PCB support, small
1	18	Hex head screw M4 x 25	24	725	Stake for flatbed
1	20	Washer 4.3	1	726	Wing nut M4
1	27	Axle tube	12	1202	Chain 200mm
1	52	Rim, chromed			

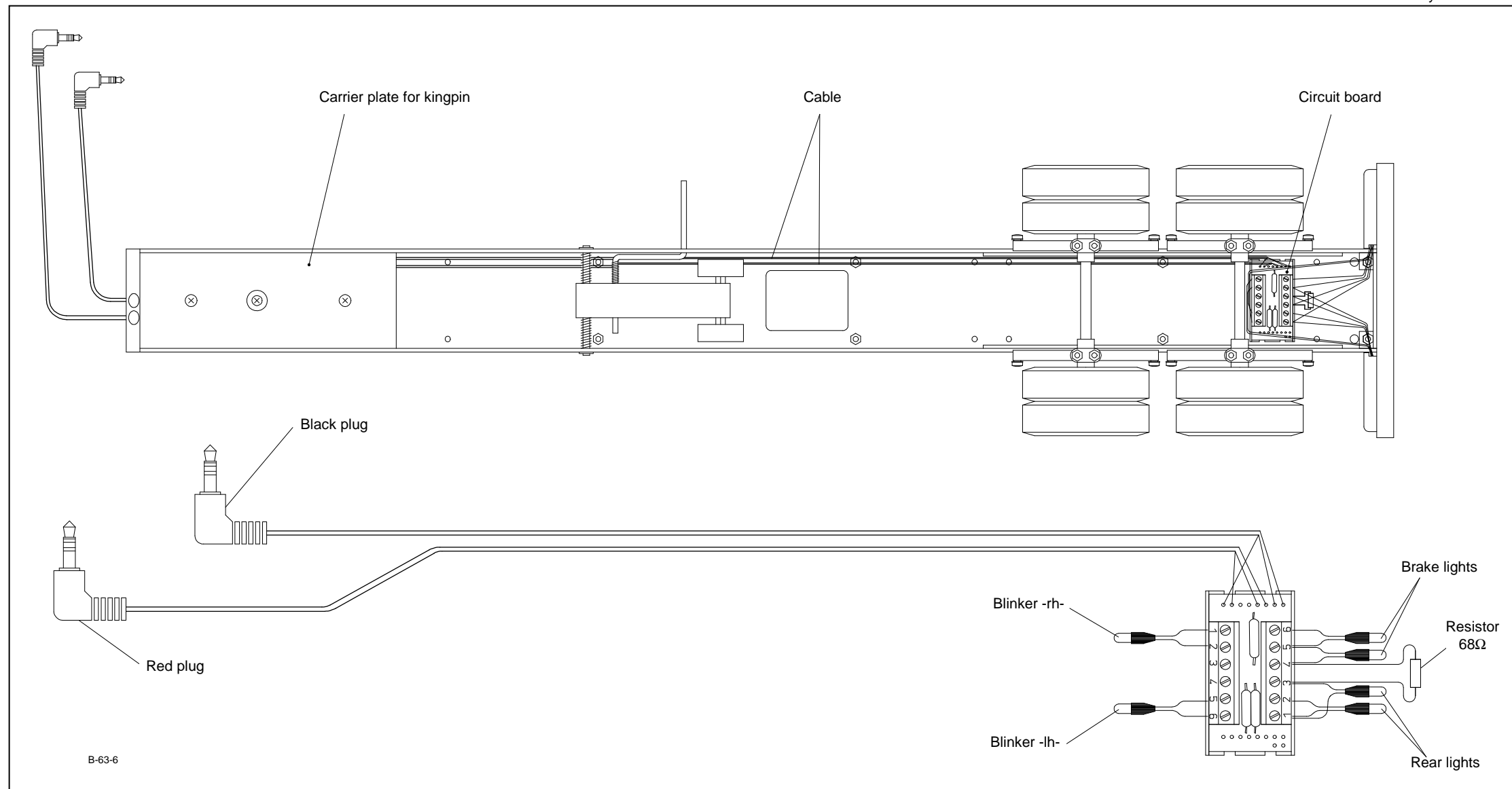

7 The electrical system

On top of the illustration you see the frame (shown from below) together with the electrical system already installed. At the bottom of this illustration you find the wiring scheme for the lighting system.

7.1 Connection to the circuit board

After having connected the blinkers and the rear lights accordingly to the drawing, clip the circuit board into the corresponding support. Embed both cables with the plugs underneath the frame and fix them using insulating tape. Surplus cable has to be rolled up and fixed under the carrier of the kingpin.

7.2 Connection to truck tractor

To get the electric of your semi-trailer working please connect as follows:

- the black marked plug to the black marked socket,
- the red marked plug to the red marked socket on the rear panel of your truck.

Attention: Due to different types of electrical systems, this semi-trailer making part of our line "Complete Kits" is not compatible with the truck tractors of the WEDICO „System Kits“. The electric of this present kit will fit the electric of all truck tractors belonging to the range of „Complete Kits“. (Please also refer to all of the notes given in the instructions for the prime movers belonging to our Complete Kits programme).

Complete list of parts necessary for the assembly (please use EDP-number when ordering spare parts)

Qty.	No.	Assembly part	EDP-No.	Qty.	No.	Assembly part	EDP-No.	Qty.	No.	Assembly part	EDP-No.	Qty.	No.	Assembly part	EDP-No.
77	---	Nut M3.....	20040	4	33	Spring medium, "AF".....	20134	2	174	Spring for landing gear.....	20182	1	647	Countersunk screw M3 x 16.....	25742
18	1	Screw M3 x 6.....	20016	4	34	Spring short, "AF".....	20136	1	175	Landing gear lever.....	20178	2	655	Adhesive pad, double-sided.....	20410
10	2	Screw M3 x 8.....	20018	1	47	Bumper, rear unpainted.....	20006	1	176	Coil spring for lever.....	20260	2	709	Lamp cap.....	20264
30	3	Screw M3 x 12.....	20022	4	52	Rim, grey.....	20128	1	177	Landing gear strut, unpainted.....	20180	6	713	Bulb 3V.....	20310
10	4	Screw M3 x 16.....	20024	5	52	Rim, chromed.....	20420	2	178	Landing gear wheel.....	24534	2	714	Mud guard.....	21272
1	5	Screw M3 x 20.....	20224	9	53	Standard tyre "Ecocontrol".....	28840	1	179	Carrier plate for kingpin.....	20186	1	715	Mudguard support "X".....	21275
2	6	Screw M3 x 25.....	20026	2	57	Screw M3 x 10.....	20020	1	180	Kingpin standard fifthwheel.....	20188	1	716	Mudguard support "O".....	21274
20	13	Washer 3.2.....	20046	2	65	Countersunk screw M3 x 12.....	20032	1	181	Frame, semi-trailer 741mm.....	20174	2	717	Mud flap.....	24074
2	15	Serrated washer 3.2.....	20054	2	68	Rear axle 144mm.....	20126	1	315	Washer 3.2 large.....	22900	1	723	PCB support, small.....	21530
4	17	Hex head screw M4 x 8.....	20036	8	70	Spring carrier, plastic.....	20138	1	336	Head panel, flatbed.....	23746	24	725	Stake for flatbed.....	23714
1	18	Hex head screw M4 x 25.....	20038	1	73	Shaft for fifthwheel.....	20012	1	337	Angled section, flatbed.....	23744	1	726	Wing nut M4.....	22906
5	20	Washer 4.3.....	20048	8	109	Nut M2.....	21208	1	356	Loading platform long.....	23752	12	1202	Chain 200mm.....	27248
2	25	Retaining washer 3.2.....	20058	8	114	Screw M2 x 6.....	21268	2	357	Side trail long.....	23762	1	---	PCB AH Complete Kit Semi-Trailer	26154
8	26	Bushing 4 x 0.5 x 7.....	20088	1	130	Bumper bracket.....	20176	2	341	Blinker lens high, orange.....	20304	1	---	Resistor 68 Ohm / 0.5 W.....	20401
1	27	Axle tube.....	20150	24	138	Bridging clamp.....	20194	2	342	Lens/rear light high, red.....	20308				
4	32	Spring long, "AF".....	20132	2	173	Axle carrier 2, sloped.....	20220	1	643	Kingpin for metal fifthwheel.....	25388				

8 General parts list

For gaining an easier overview of all single components and their necessary quantity for the correct assembly of this model, on the left side of this page you find a complete list including each single item. For reasons of packaging some of the small parts are packed in a higher number of pieces than necessary. On the left side you find the quantity mentioned for each part. Next to this column you find the numbers of the assembly parts and their terms, followed by the EDP-numbers to be used when re-ordering one or the other item.